

7.

TEXAS AVENUE
WATER & SEWER IN ST. R/W

S 22-10E -

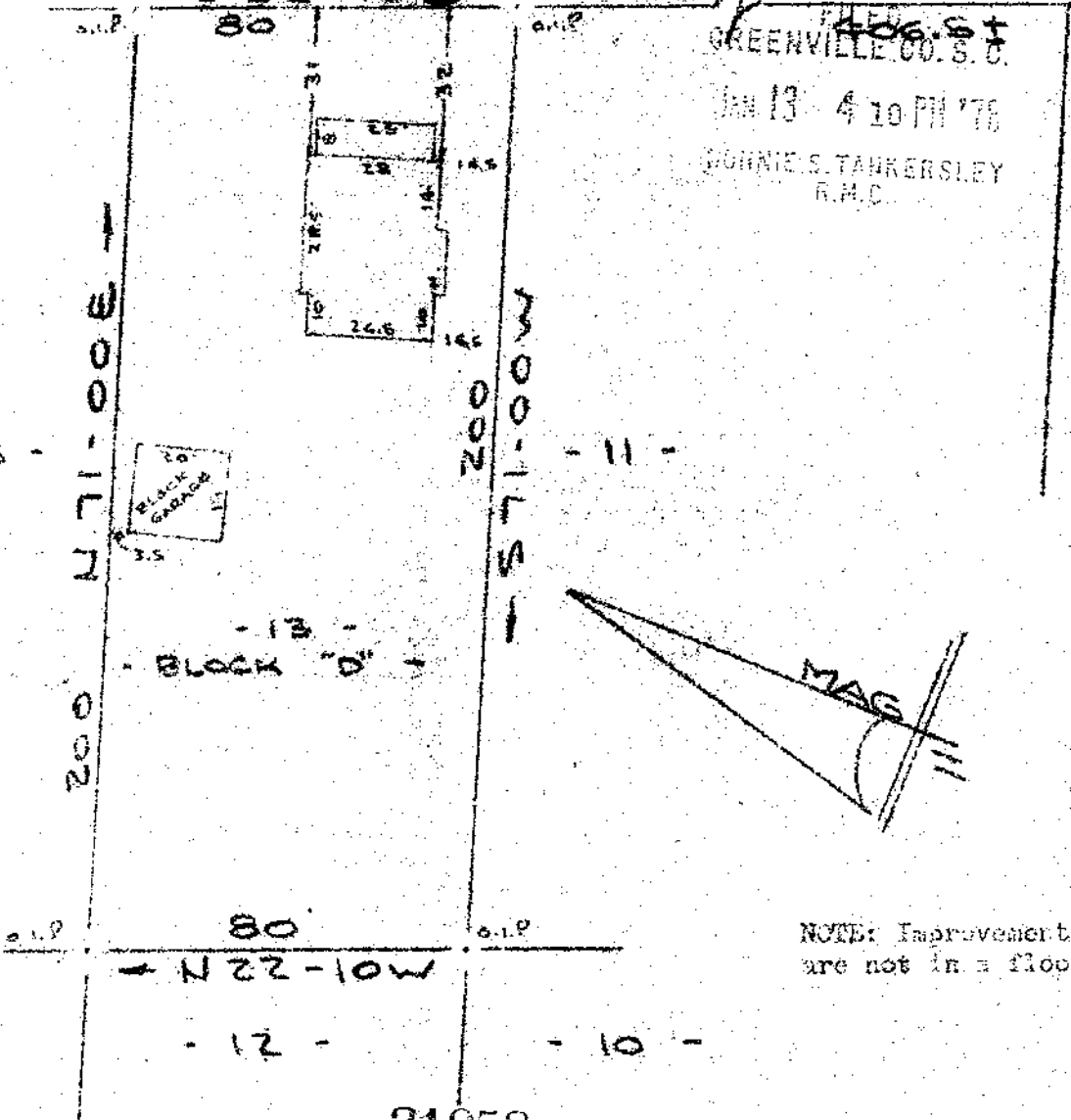

FILED 406.64
GREENVILLE CO. S. C.
JAN 13 4 10 PM '76
JOHNIE S. TANKERSLEY
R.M.C.

EASLEY BRIDGE ROAD

NOTE: Improvements on this lot are not in a flood hazard area.

21058

✓ 6-2-51

PROPERTY OF

MALVIN E. NORRIS & KATHY J. NORRIS

NEAR GREENVILLE, S. C.

SCALE: 1"=40'

22 DEC 1977

This is to certify that on the 22nd day of December, 1977, I surveyed the property shown on this plat, being known as lot 13 Block "D" on plat of HIGHLAND SUBDIVISION and recorded in the RMC Office Greenville County, S. C., in Plat Book "E" at Page 209; and that the property lines, walls and buildings are as shown hereon, and that the walls and buildings located on said lot do not encroach or project on adjacent street or property, and that no adjacent walls or buildings encroach or project on said premises, and no power lines cross this property except as shown hereon.

P. B. Bruce
P. B. Bruce, RLS

GREENVILLE SURVEYING CO.

112 Main St., Greenville, S.C.

MICROFILMED

GCT10 --- 1 JAN 13 '78

238

1.00CI

227-4-8